

Welcome to The St Mary-le-Tower 9th Annual Grand Christmas Tree Festival

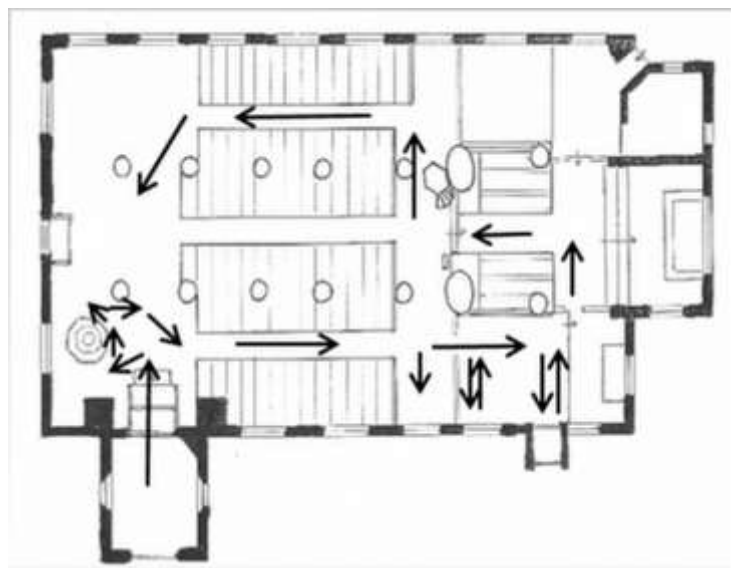

Please follow the one way route around church indicated by the arrows.

Festival Tree Guide

*To save the environment,
please return this guide after
use – Thank you*

No	Organisation	No	Organisation
1	SMLT Bellringers & Friends - Christmas Bells Round the World	12	Sandy Martin MP for Ipswich Representing the people of Ipswich in Parliament
2	Ace is an independent advocacy organisation based in Suffolk.	13	Emma's Florist 'Flowers for all Occasions'
3	Psychiatric Liaison Service; Ipswich Hospital	14	Northgate High School's Tree of Kindness - No act of kindness, no matter how small, is ever wasted - <i>Aesop</i>
4	Porch Tree –	15	Red Rose Chain Theatre Company – 'enriching entire communities'
5	Porch Tree –	16	Girlguiding Ipswich
6	Strutt & Parker - Deck the Halls...and all the other rooms too	17	Pillar Tree – Kindly sponsored by a member of the congregation (1)
7	Ipswich Hospital Band & St Peter's Band - based at St Peter's by the Waterfront - a centre for Music and The Arts	18	Pillar Tree – Kindly sponsored by a member of the congregation (2)
8	East of England Co-op Funeral Services Remembering loved ones this Christmas	19	Pillar Tree – Kindly sponsored by Abbeyfield Orwell Extra Care Society
9	The Beeston Family Tree	20	Pillar Tree – Kindly sponsored by Associated British Ports
10	Avenues East - Enabling people with disabilities to play an active part within their local community	21	Suffolk members of the Guild of Machine Knitters. We knit for families and friends and charities
11	Cancer Campaign In Suffolk Here to Help Before During and after Cancer	22	Hunnaball of Ipswich and Spring Road. Your local family funeral directors

No	Organisation	No	Organisation
23	Norwood Residential Home –improving the lives of older people inspired by Christian concern.	40	The Book Group
24	Pillar Tree – Kindly sponsored by AXA Insurance	41	Suffolk District Girls’ Brigade – Fun, Friends and Fellowship
25	Pillar Tree – Kindly sponsored by Barefoot & Gilles	42	Tower St Print Project welcomes people of all ages and abilities to learn printmaking skills and discover their creativity
26	Pillar Tree – Kindly sponsored by Castons	43	Ipswich Unitarian Meeting
27	Pillar Tree – Kindly sponsored by Charles Stanley	44	Sue & Mark Hollingsworth
28	CACHSF - Raising the profile of health and wellbeing within the African and Caribbean communities	45	Suffolk User Forum Your voice for emotional wellbeing and mental health
29	Ellie’s Fund - Supporting creative activities and projects for people with mental health problems	46	Royal National Lifeboat Institution - The Graham Family
30	Ipswich Disabled Advice Bureau	47	Jackamans Solicitors - were here to help. 'There's snow business like Jackaman's business!'
31	Suffolk Constabulary - Making Suffolk a safer place to live, work, travel and invest	48	Memories and Stars
32	Slimming World	49	St. Helen’s Pre-school Playgroup – providing care and education for 2 to 4 year olds.
33	ORWELL WALK, RUN & CYCLE - The Ipswich East Rotary Club	50	Ipswich Diabetes UK Support Group - helping those living with diabetes in the local community.
34	Pillar Tree – Kindly sponsored by Choral Foundation For St Mary-le-Tower	51	Ipswich Shopmobility (Ipswich Borough Council)
35	Pillar Tree – Kindly sponsored by Coes	52	Devere Care Oakwood House
36	Pillar Tree – Kindly sponsored by East of England Co-op Funeral Services	53	Memory Tree - The Fisk Family
37	Pillar Tree – Kindly sponsored by Ellisons	54	Busy Bees Nursery and Preschool Ipswich, Rushmere
38	ABC Childcare - Make your childcare as easy as ABC!	55	11th Ipswich Wednesday Cubs
39	Pins & Needles at St Mary-le-Tower - a happy place to knit, stitch, crochet or craft	56	Ipswich Flower Club - fun and friendship with flowers

No	Organisation	No	Organisation
57	Pennikkity Pots Ceramics Café -Ceramic Painting & Clay Studio	74	ZEST - Part of the St Elizabeth Hospice family
58	Citizens Advice Ipswich. Local charity providing free, impartial and confidential advice on rights & responsibilities	75	Foresters Friendly Society - Brave Old Oak Court 3658.
59	Inner Wheel Club of Ipswich Orwell – promoting friendship, encouraging personal service, fostering international understanding.	76	St Mary-le-Tower Church Tree – kindly donated by Willis Towers Watson
60	Ipswich Opportunity Group – play and support for families who have pre-school children with additional needs.	77	HELP OUR HOMELESS a co-ordinated multi-agency initiative to raise awareness of the help available to people who are homeless in Ipswich.
61	Kerseys Solicitors LLP - Representing personal and business clients across East Anglia	78	The Bumblebee Children's Charity "Supporting babies and young children with physical disabilities
62	Ipswich Bach Choir - A friendly choir	79	Rushmere Hall Primary School Outdoor Explorers Club
63	Ipswich Housing Action Group - The Chapman Centre. A place of change for single homeless people In Ipswich	80	Paperchase wishes everyone a very Happy Christmas
64	Supporting mothers whose children do not live with them.	81	Ipswich and District Amnesty International Group
65	Mothers' Union St Mary at Stoke Branch	82	Headway Suffolk - Professor Stephen Hawking Neuro Centre
66	PRAYER TREE by the Congregation of the Wednesday Communion	83	The Rotary Club of Ipswich Orwell -sharing friendship and helping communities locally, nationally and internationally.
67	Talitha Koum provides compassion and practical support to women facing a variety of traumatic vulnerable circumstances	84	Suffolk Archives Foundation (SAF) - supporting Suffolk Record Office to protect, preserve & promote 900 years of historic collections
68	St Mary-le-Tower Lunchtime Concerts	85	Perspectives Ipswich. A pregnancy listening & Support Service Registered Charity No 1070518
69	LIFT(Ladies in Fellowship Together) - Fun with Fabric Scraps	86	Ipswich Ripple Food Co-op
70	The Choristers of St Mary-le-Tower	87	Helping our feline friends
71	YMCA Childcare Providence part of YMCA Trinity group	88	Pillar Tree – Kindly sponsored by EWS
72	Henley Primary School	89	Pillar Tree – Kindly sponsored by Gotelee
73	Units from Westgate District, Ipswich West Division. Members of Girlguiding.	90	Pillar Tree – Kindly sponsored by Ipswich Central

No	Organisation	No	Organisation
91	Pillar Tree – Kindly sponsored by Ipswich School	105	St Edmundsbury & Ipswich Diocese Mothers' Union
92	The Ace Project - supporting young people to Achieve, Connect and Enjoy for wellbeing	106	Jackson-Stops Property Experts Since 1910
93	St Margarets Baby and Toddler Group	107	Suffolk Refugee Support 'Rebuilding lives in Suffolk' (Charity No 1078794)
94	Christians Against Poverty – passionate about lifting people out of debt and bringing good news, hope and freedom	108	Pillar Tree – Kindly sponsored by Sackers
95	Ipswich Institute Reading Room & Library - and so much more... An inspiring heritage	109	Pillar Tree – Kindly sponsored by Scograil Scograil
96	Rushmere Hall Primary School Lego Club	110	Pillar Tree – Kindly sponsored by Scrutton Bland
97	Pillar Tree – Kindly sponsored by John Olivers	111	Pillar Tree – Kindly sponsored by Waterfront Life
98	Pillar Tree – Kindly sponsored by Kerseys Solicitors	112	Pillar Tree – Kindly sponsored by Willis Towers Watson
99	Pillar Tree – Kindly sponsored by Kite Opticians	113	Pillar Tree – Kindly sponsored by Wines Of Interest
100	Pillar Tree – Kindly sponsored by MSC	114	Coes – personal style since 1928
101	The Animals came marching two by two - Please play and explore	115	The Arts Society South East Suffolk
102	Children's craft creations displayed.	116	St Elizabeth Hospice – We don't let death kill life.
103	The Kingdom of Heaven is like a Mustard Seed – Please play and listen to the birds	117	West end Church Entrance Tree
104	Children's interactive tree – Advent Calendar. Please play and follow the Story of Christmas	118	West end Church Entrance Tree

*To save the environment
please return this guide
after use. Thank you.*