

# Welcome to The St Mary-le-Tower 10<sup>th</sup> Annual Grand Christmas Tree Festival

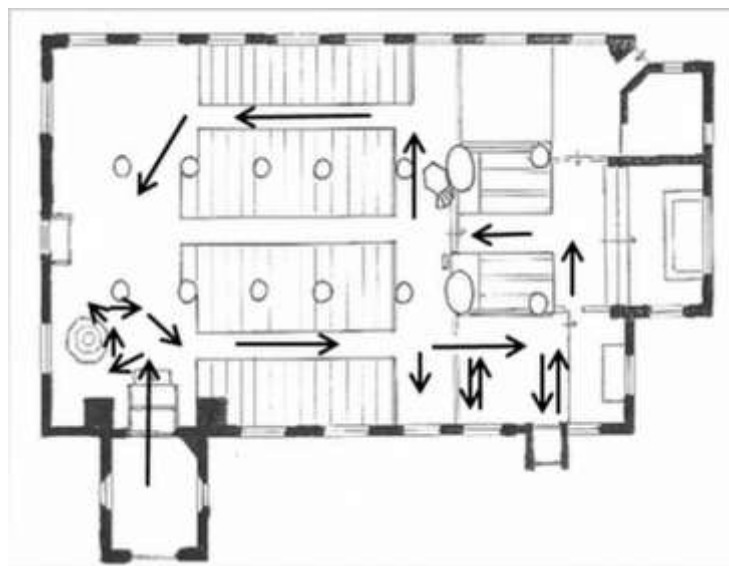

**Please follow the one way route around church indicated by the arrows.**

## Festival Tree Guide

*To save the environment,  
please return this guide after  
use – Thank you*

No	Organisation	No	Organisation
1	SMLT Bell ringers & Friends - Christmas Bells Round the World	12	'Made With Love' tree Handmade by supporters, upcycled from donations, made with love to raise money for St Elizabeth Hospice.
2	Psychiatric Liaison Service; Ipswich Hospital	13	St John Ambulance Badgers - fun, adventure, and learning first aid.
3	Got To Read - Helping adults become confident readers	14	Suffolk User Forum Your Voice for Emotional Wellbeing and Mental Health
4	Porch Tree –	15	Slimming World - Touching hearts, changing lives.
5	Porch Tree –	16	Magpie Artists - Three women creating art in Ipswich
6	Ipswich Bach Choir - A friendly choir	17	Pillar Tree – Kindly sponsored by a member of the congregation (1)
7	Ipswich Hospital Band & St Peter's Band - based at St Peter's by the Waterfront - a centre for Music and The Arts	18	Rotary Club of Ipswich Orwell- sharing friendship and helping communities locally, nationally and internationally
8	East of England Co-op Funeral Services Remembering loved ones this Christmas	19	Ipswich Unitarian Meeting
9	Norwood Residential Home –improving the lives of older people inspired by Christian concern.	20	Rainbow, Brownie and Guide Units from Westgate District, Ipswich West Division.
10	The Arts Society South East Suffolk	21	Pillar Tree – Kindly sponsored by a member of the congregation (2)
11	Headway Suffolk- helping local people with a neurological condition	22	Pillar Tree – Kindly sponsored by a member of the congregation (3)

<b>No</b>	<b>Organisation</b>	<b>No</b>	<b>Organisation</b>
23	Pillar Tree – Kindly sponsored by Abbeyfield Orwell	40	Suffolk Law Centre: Offering free legal advice all year round.
24	Pillar Tree – Kindly sponsored by AXA Insurance	41	Pillar Tree – Kindly sponsored by Framlingham College
25	Suffolk District Girls’ Brigade – Fun, Friends and Fellowship	42	Pillar Tree – Kindly sponsored by Fred Olsen Travel
26	Red Rose Chain- The Magic Fishbone	43	Pillar Tree – Kindly sponsored by Gotelee Solicitors
27	The Ipswich Institute. An inspiring heritage to advance the education of the inhabitants of Ipswich and the surrounding area	44	Pillar Tree – Kindly sponsored by Ipswich Central
28	Ipswich Central Christian Aid Committee – Local churches supporting our poorest worldwide neighbours	45	Ipswich Opportunity Group = play and support for families who have pre-school children with additional needs
29	Girlguiding Ipswich	46	Cake and Revolution WI – making the traditional modern, improving the lives of local women and supporting local charities
30	Ipswich Disabled Advice Bureau	47	Ellie’s Fund – Supporting creative activities and projects for people with mental health problems
31	John Olivers Hairdressing Group – ‘It’s all about hair’	48	Hunnaball of Ipswich & Spring Road Your local family funeral directors
32	Pillar Tree – Kindly sponsored by Barefoot & Gilles	49	Suffolk Archives and the Hold – Connect, Explore, Discover!
33	Pillar Tree – Kindly sponsored by Charles Stanley	50	Jackamans Solicitors - Defrosting your legal issues
34	Pillar Tree – Kindly sponsored by Choral Foundation For St Mary-le-Tower	51	The Ipswich Hospital Baby Bereavement & Early Pregnancy Loss Group- ‘Always in our Hearts’
35	Pillar Tree – Kindly sponsored by East of England Coop Funeral Services	52	Kaleidoscope Eye x Rockafella Industries. 8 Eagle St, Ipswich
36	Ipswich Diabetes UK Support Group - helping those living with diabetes in the local community.	53	Change in Charcoal – the Valerie Irwin Archive Project
37	Cancer Campaign in Suffolk - Helping before, during and after a cancer diagnosis	54	Jackson-Stops Estate Agents – Specialists in Prime Residential Property
38	Perspectives Ipswich. A pregnancy listening and support service for pregnancy loss	55	St Margaret’s baby and toddler group
39	CACHSF - Raising the profile of health and wellbeing within the African and Caribbean communities	56	The Book Group

<b>No</b>	<b>Organisation</b>	<b>No</b>	<b>Organisation</b>
57	Ipswich Tangent 180	77	Church Tree
58	11th Ipswich Wednesday Cubs	78	R Gwinnell & Sons - 'Treasured Memories'
59	Pennikkity Pots Ceramics Café -Ceramic Painting & Clay Studio	79	Paperchase Ipswich
60	The Bumblebee Childrens Charity -."Supporting babies and young children with physical disabilities"	80	LGBTree - Matilda Cutting, Veronika Cutting and Hannah Cooper (Choral Scholars at SMLT)
61	Quayside Day Nursery and Pre-school	81	ABC Childcare - Make your childcare as easy as ABC!
62	Lighthouse Women's Aid	82	Citizens Advice Ipswich – 'Here to Help', 'Don't worry
63	Rushmere Hall Primary School Green Team.	83	Emmaus Suffolk – working with and for the homeless
64	YMCA Childcare Providence - 'Family Festive Fun'	84	Jenkin Family Tree
65	Lions Club of Ipswich "We Serve"	85	The ACE Project – supporting young people to Achieve, Connect and Enjoy for wellbeing.
66	Supporting mums whose children live outside their care.	86	Volunteering Matters – For Young People
67	St Mary at Stoke Mothers Union	87	SMLT Lunchtime Concerts
68	Wednesday Communion Fellowship	88	Woodcraft Folk Elfins
69	St Edmundsbury and Ipswich Mothers Union	89	Friends of the Earth Ipswich
70	The Graham Family – A Child's Prayer	90	Guy Cry Club: A creative dialogue on mental health, masculinity and sexuality
71	Choristers of St Mary-le-Tower	91	Fisk Family Tree - A Christmas Carol
72	Pins & Needles	92	Pillar Tree – Kindly sponsored by Ipswich High School
73	Gio's Sweet Treats - Making all events "Truly Scrumptious"	93	Pillar Tree – Kindly sponsored by Ipswich School
74	Roundabout Nursery	94	Pillar Tree – Kindly sponsored by Jillian Lofts
75	50 Shades of Pink - Susan Andrews	95	Pillar Tree – Kindly sponsored by Kite Opticians
76	St Margaret's CEVA Primary	96	Canadian Christmas

No	Organisation	No	Organisation
97	Ipswich East Rotary Club	111	Strutt & Parker – Deck the Halls...and all the other rooms too
98	Outreach youth - Supporting LGBTQ+ young people	112	Pillar Tree – Kindly sponsored by Scograil
99	LIFT (Ladies in Fellowship Together) - Starry Night	113	Pillar Tree – Kindly sponsored by Seven Assets Management
100	Ipswich Cats Protection Helping our feline friends	114	Pillar Tree – Kindly sponsored by The Greyhound
101	Thomas Wolsey Ormiston Academy	115	Pillar Tree – Kindly sponsored by The Baldry Family
102	"Ipswich Choral Society Proudly singing since 1824"	116	Suffolk Constabulary – making Suffolk a safer place to live, work, travel & invest.
103	Pillar Tree – Kindly sponsored by Members of the St Mary-le-Tower Congregations	117	Northgate High School –Together in Unity for Harmony and Equity
104	Pillar Tree – Kindly sponsored by MSC	118	Suffolk Refugee Support 'Rebuilding lives in Suffolk' (Charity No 1078794)
105	Pillar Tree – Kindly sponsored by Royal Hospital School	119	Pillar Tree – Kindly sponsored by Wines of Interest
106	Pillar Tree – Kindly sponsored by Sackers	120	Coes of Ipswich
107	The Animals came marching two by two - Please play and explore	121	St Joseph's College Prep School
108	The Chapman Centre (Ipswich Housing Action Group) – providing advice and support as the homelessness hub for Ipswich.	122	St Elizabeth Hospice – We don't let death kill life.
109	The Kingdom of Heaven is like a Mustard Seed – Please play and listen to the birds	123	West end Church Entrance Tree
110	Children's interactive tree – Advent Calendar. Please play and follow the Story of Christmas	124	West end Church Entrance Tree

*We hope you have enjoyed your visit*

*To save the environment  
please return this guide  
after use. Thank you.*